

NORMY POLSKA

PN-75/M-35412 - DNO ELIPSOIDALNE

$h_w = 0.25 * D_w$

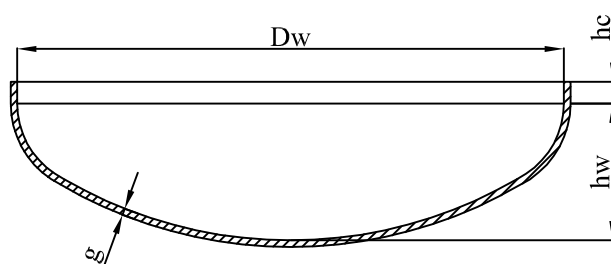

PN-69/M-35413 - DNO O MAŁEJ WYPUKŁOŚCI

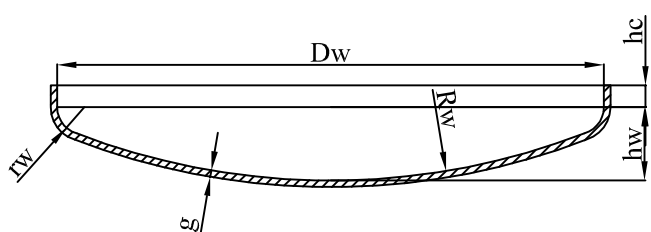

PN-69/M-35414 - DNO PŁASKIE

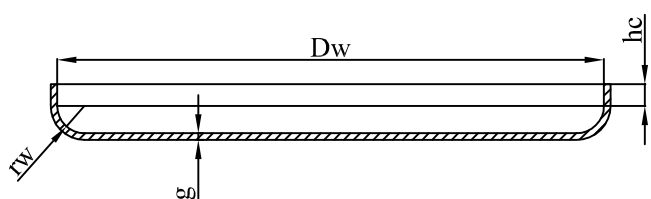

PN-EN 12285 - DNO SKLEPIENIOWE

$r_1 \leq d_1$
 $r_2 = d_1 / 30$

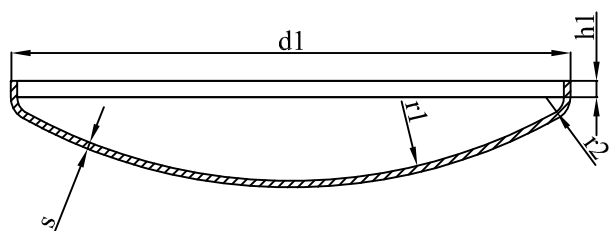

**PN-EN 13445-4 - DNO WYPUKŁE
 (norma lub dokumentacja klienta)**

